



LAYOUT PLAN OF DIET CAMPAS AT ABDARPUR,  
SURI/ BIRBHUM.

LAND AREA=26176.00 SQ.M  
COVER AREA=1319.00 SQ.M  
VACATE LAND=~~24860.00 SQ.M~~ 2152.52 SQ.M  
24,023.48 SQ.M

Mouja - Abdarpur.  
J.L. - 97, Plot - 271  
P.S. - Suri.

Executive Engineer,  
Birbhum Division  
P. W. ( C. B. ) Dto

N. H-60 SURI BY -PASS ROAD.

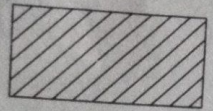

D- TYPE QRTS. Area=78.10  
sq.m

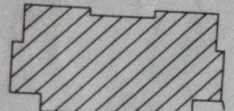

PUMP  
HOUSE



21.24 S-M

C-TYPE QTR  
Area=97.60

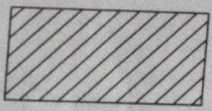

KITCHEN.

Area=80.43 sq.m

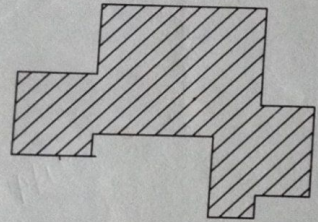

BOYS HOSTEL  
Area=185.08 sqm x2  
=370.16 sq.m

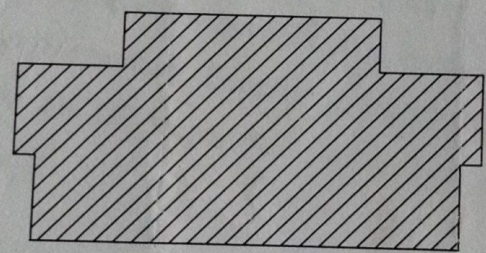

INSTITUTE BUILDING

Area=463.37 sq.m x2  
=926.74 sqm

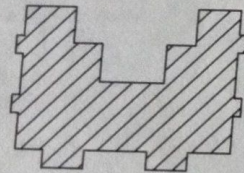

TECH.STAFF QRTS.

Area=124.95 sq.m

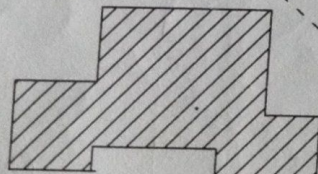

LADIES HOSTEL  
Area=185.08 sq mx2  
=370.16 sq.m

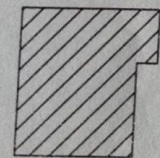

PRINCIPAL QTRS.  
83.14 sq.m

CULVERT

TOTAL AREA OF PLINTH

i)NON. RESI---1028.41 SQ.M

ii)Resi. Portion.--1124.11 sq.m

2152.52 sq.m

*[Handwritten signature]*  
11/2/00

Executive Engineer,  
Birbhum Division  
P. W. ( C. B. ) Dto